

PART NO.	PART NAME	M A T E R I A L				
		CAST IRON	CAST STEEL	SS 304	SS 316	ALLOY 20
1	BODY	IS 210 FIG.200	ASTM A-216 GR.WCB	ASTM A-351 GR.CF 8	ASTM A-351 GR.CF 8M	ASTM A-351 GR.CN 7M
2	BONNET	"	"	"	"	"
3	DISC	13% Cr. SS	13% Cr. SS	SS 304	SS 316	"
4	SEAT	"	"	INTEGRAL WITH BODY		
5	STUD	EN 9	193-B7	AISI-304	AISI-304	AISI-304
6	NUT	EN 8	194-2H	"	"	"
7	GASKET	SS304 SPW with Graphoil filler				

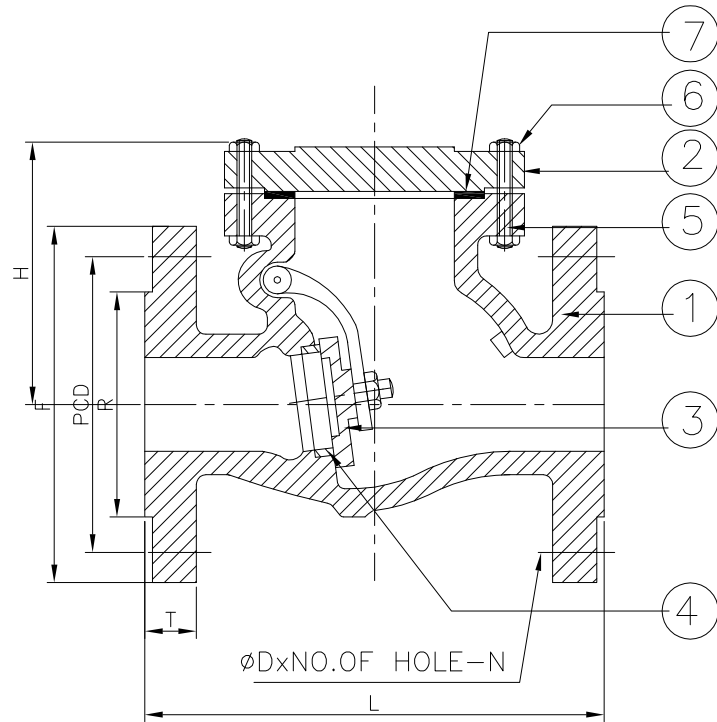

ALL DIMENSIONS ARE IN MM.

SIZE NB	L	H	F	R	T	PCD	ØD x N
50	203	150	152	92	16	121	19 x 4
65	216	175	178	105	17	140	19 x 4
80	242	185	191	127	19	152	19 x 4
100	292	225	229	157	24	191	19 x 8
125	356	250	254	186	24	216	22 x 8
150	407	270	279	216	25	241	22 x 8
200	495	325	343	270	29	298	22 x 8

NOTE:-

1. FLANGES WILL BE DRILLED AS IN THE TABLE UNLESS OTHERWISE SPECIFIED.
2. STELLITE WORKING PARTS ARE PROVIDED IF SPECIFICALLY REQUIRED

NOTE:- ALL DIMENSIONS ARE IN mm IF NOT SPECIFIED.

Test Pressure:

Hyd. Body : 32 Kg/cm²
Hyd. Seat : 22 Kg/cm²

CLIENT :-			
P.O.No :- --			
SCALE :-	SHEET :-	DRAWING No.	REV.
FILE :- 01	DATE :- 23/09/13	AFSGV300RF	00
TITLE :- CHECK VALVE FLANGED ENDS, 150#.		PROJECTION :-	
 www.strainersindia.com		L - 153, Nr.WATER TANK, G.I.D.C. ODHAV, AHMEDABAD.	
		NAME	DATE
ACAD BY	BJS	23/09/13	
CHED BY	BJS	23/09/13	
APPD BY	RS	23/09/13	